

REVISIONS				
REV.	DATE	DESCRIPTION	ECO	BY
A	03/16/2007	RELEASE FOR PRODUCTION	11562	RLH

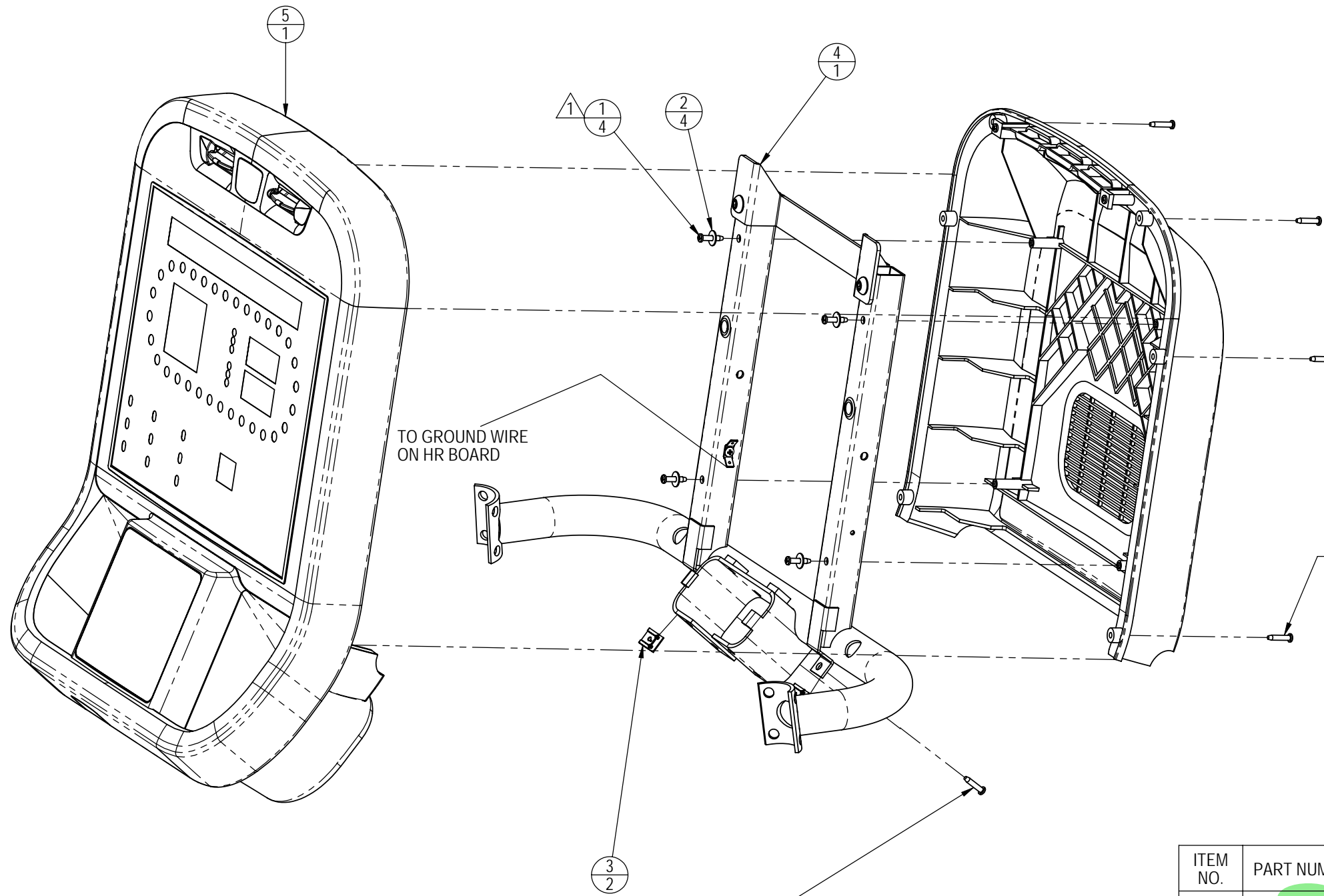

2X - (REFERENCE) USE PART NUMBER 110-3402 FROM THE BAG IN ASSEMBLY 711-3196 TO ATTACH FRONT TO 711-3208.

6X - (REFERENCE) USE PART NUMBER 110-3402 FROM THE BAG IN ASSEMBLY 711-3196 TO ATTACH FRONT TO BACK.

ITEM NO.	PART NUMBER	DESCRIPTION	QTY.
1	110-3402	SCREW, M4x0.7x19L,PHT,PH,CS,BZ	4
2	120-3307	WASHER, M4, 4.3mm I.D. X 12mm O.D., ISO 7089	4
3	140-3323	U-NUT, #8, PANEL .025-.125	2
4	711-3208	ASSY, DISP. WELD. w/ HARDWARE, PRO ST	1
5	711-3196	ASSY, DISPLAY ELEC, LED, E-ST	1

NOTES:
 1 APPLY 13-17 lb-in / 1.5-1.9 N-m OF TORQUE TO SCREWS (110-3403).

DOCUMENT STATUS:
 RELEASE

NOTICE OF PROPRIETARY INFORMATION
 THIS DOCUMENT SHALL NOT BE REPRODUCED NOR SHALL THE INFORMATION CONTAINED HEREIN BE USED BY OR DISCLOSED TO OTHER EXCEPT AS EXPRESSLY AUTHORIZED BY UNISEN

MATERIAL SEE BOM		TOLERANCES UNLESS OTHERWISE SPECIFIED X.XXX = ± .010" (0.25MM) ANGLES = ± 2° X.XX = ± .030" (0.76MM) FRACTIONS = ± 1/32 X.X = ± .050" (1.27MM) X = ± .125" (3.20)		UNISEN, INC. DBA 14410 Myford Road Irvine CA 92606	
FINISH SEE BOM		INITIAL DRAWN JRT	DATE 02-05-07	PART NO. 711-3210	REV A
VENDOR: N/A		P/N: N/A		TITLE ASSY, DISPLAY LED & WELDMENT,E-ST	
		U.O.M. INCH	SCALE: 1:4	SHEET 1 OF 1	SHEET SIZE: B